



DOLCE & GABBANA

MANUALE D'USO  
INSTRUCTION MANUAL

USER MANUAL

MILK FROTHER

EN

MANUEL DE L'UTILISATEUR

CHOCOLATIÈRE

FR

MANUAL DE USO

VAPORIZADOR DE LECHE

ES



**Important information for the user**  
**Informations importantes pour l'utilisateur**  
**Información importante para el usuario**

 **Instructions / Instructions / Instrucciones**

 **Description / Description / Descripción**

 **Use / Utilisation / Uso**

 **Cleaning and care / Nettoyage et entretien / Limpieza y cuidado**

 **Safety instructions / Consignes de sécurité / Instrucciones de seguridad**

 **Information / Informations / Información**

 **Advice / Conseil / Recomendaciones**

Dear Customer, Thank you for choosing this special edition Smeg – Dolce&Gabbana, Blu Mediterraneo small domestic appliance. Smeg and Dolce&Gabbana have combined their artistic talents to create a unique collection, made in Italy by Smeg with unmistakable Dolce&Gabbana design touches. We hope you enjoy using your new appliance! Kindest regards.

Cher client, Nous vous remercions d'avoir acheté un petit appareil électroménager de l'édition spéciale Smeg – Dolce&Gabbana, Blu Mediterraneo. Smeg et Dolce&Gabbana associent leurs veines artistiques donnant vie à une collection unique, originale Made in Italy, réalisée par Smeg avec une créativité unique signée Dolce&Gabbana. Nous espérons que vous pourrez apprécier pleinement votre appareil électroménager, nous vous présentons nos salutations les plus cordiales.

Estimado/a cliente, Le agradecemos por haber escogido un pequeño electrodoméstico de la edición especial Smeg – Dolce&Gabbana, Blu Mediterraneo. Smeg y Dolce&Gabbana unen sus espíritus artísticos, dando vida a una colección única, original «Made in Italy», realizada por Smeg con la inconfundible expresividad creativa de Dolce&Gabbana. Deseamos que disfrute al máximo de todas las funciones de su electrodoméstico, le enviamos nuestros saludos más cordiales.

**SMEG S.p.A.**

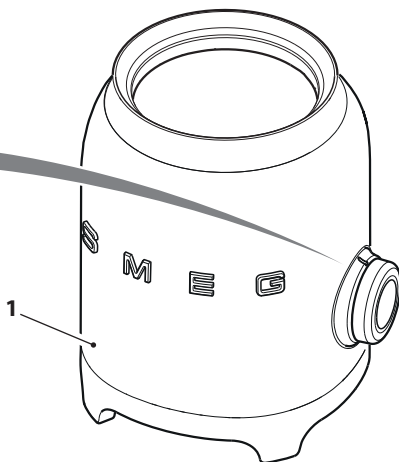
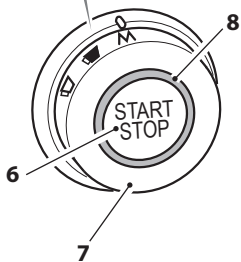
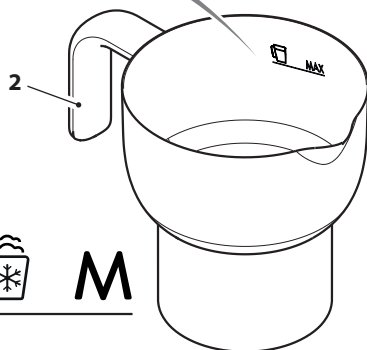
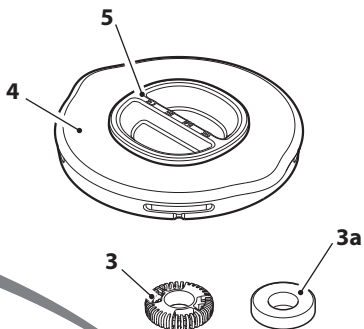
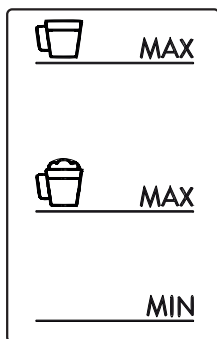

220-240V~ 50/60Hz  
500 W

Fig. "1"  
Abb.



# Important instructions

## Important instructions

ZE

**WARNING:** If the instructions contained in this manual are not followed precisely, fire or explosion may result causing property damage, personal injury or death.



**READ AND SAVE THESE INSTRUCTIONS** - Your safety and the safety of others are very important.

We have provided many important safety messages throughout this manual and on the appliance.

Read all the instructions before using the appliance and always obey all safety messages.

### **WARNING**



- **To reduce the risk of fire or electric shock, do not remove the cover (or back).**
- **No user-serviceable parts inside!**
- **Repair should be done by authorized service personnel only.**

# Important instructions



## RECOGNIZE SAFETY INFORMATION

This is a safety alert symbol. This symbol alerts you to potential hazards that can result in severe personal injury or death.

## UNDERSTAND SIGNAL WORDS

A signal word - DANGER, WARNING or CAUTION - is used with the safety alert symbol. DANGER denotes the most serious hazards. It means you could be killed or seriously injured if you do not immediately follow the instructions.

WARNING means you could be killed or seriously injured if the instructions are not followed. CAUTION indicates a potentially hazardous situation, which, if not avoided, could result in minor to moderate injury.

## WARNING



- **This appliance is intended for household use only.**
- **Use this appliance only for its intended purpose. The manufacturer cannot be held liable for damage caused by improper use of this appliance.**
- **This appliance complies with current safety regulations. Improper use of this appliance can result in personal injury and material damage.**
- **Read all the instructions before installing or using the appliance for the first time.**
- **Keep these operating instructions in a safe place and pass them on to any future user.**

The safety messages will inform you of potential hazards, on how to avoid the risk of injury and what can occur if the instructions are not followed.

**IMPORTANT: Observe all codes and ordinances in force.**

**WARNING: For your safety, the instructions contained in this manual must be followed to minimize the risk of fire or explosion and to prevent property damage, personal injury or death.**

Do not store or use gasoline or other flammable vapors, liquids or materials near this or any other appliance.



**NOTE :** This appliance is NOT designed for installation in manufactured (mobile) homes or in recreational vehicles (RVs).

**DO NOT install this appliance outdoors.**



# Important Safeguards

## WARNING



**When using electrical appliances, basic safety precautions should always be followed to reduce the risk of fire, electric shock, and/or injury to persons including the following:**

Follow all safety precautions to ensure safe use of the appliance.

- Read all instructions.
- Do not use the appliance outdoors.
- This appliance is for household use only.
- Do not use the appliance for other than its intended use.
- Misuse could lead to fires, electric shocks or personal injury.
- Do not allow children to use the appliance.
- Children should not play with the appliance. Keep the appliance out of the reach of children.
- Keep the packaging material (plastic bags, expanded polystyrene) out of the reach of children.
- Close supervision is necessary when any appliance is used by or near children.
- Turn off the appliance immediately after use.
- Do not leave the appliance unattended while it is running.
- Disconnect the appliance from the wall outlet before assembly, disassembly, cleaning and after each use.
- To disconnect, turn any control to the off position, then remove plug from wall outlet.
- Unplug from outlet when the appliance is not in use, and before cleaning. Allow to cool before putting on or taking off parts,

and before cleaning the appliance.

- To protect against fire, electrical shock and personal injury, do not immerse the appliance, the power cord or plug in water or any other liquid.
- Do not touch the appliance or the plug with wet hands.
- Never try to extinguish a flame/fire with water: turn off the appliance, unplug it from the outlet and cover the flame with a lid or a fire blanket.
- Do not use the appliance if the power cord or plug is damaged or if the appliance has been dropped or damaged in any way.
- Do not let cord hang over edge of table or counter, or touch hot surfaces.
- Do not operate any appliance with a damaged cord or plug or after the appliance malfunctions, or has been damaged in any manner. Return appliance to an authorized service facility for examination, repair or adjustment.
- Make sure the power cord does not come in contact with sharp edges.
- Do not pull on the cord to remove the plug from the socket.
- Do not place on or near a hot gas or electric burner, or in a heated oven.

## SAVE THESE INSTRUCTIONS



# Important Safeguards



- Do not touch hot surfaces. Use handles and knobs.
- Do not place the appliance near faucets or sinks.
- Never attempt to repair the appliance yourself or without the help of a qualified technician. Failing to do this will void the warranty.
- In case of malfunction, have the appliance repaired by a qualified technician.
- Do not make any changes to the appliance.
- Make sure that the power outlet used is always freely accessible, because only in this way can it be unplugged when necessary.
- To remove the plug from the power outlet, operate directly on the plug. Never pull the cable, it could be damaged.
- If the appliance should break down, do not attempt to repair it.  
Switch the appliance off, remove the plug from the power outlet and contact the Technical After-sales centre.
- If the plug or power supply cable are damaged, have them replaced exclusively by the Technical After-sales centre, so as to prevent all risks.
- Scalding may occur if the lid is removed during the brewing cycles.
- This appliance is not intended for use by persons (including children) with physical, sensory or mental impairments, or lack of experience and knowledge, unless they have been given supervision or instruction concerning use of the appliance by a person responsible for their safety.
- Danger of burns! The surface of the jug during and after use is hot. Do not touch it.
- Do not use the appliance without liquid. Always fill at least up to the MIN level and not over the MAX level. Both shown inside the jug.
- The milk foam disks can pose a risk of suffocation. Keep disks out of the reach of children.

## SAVE THESE INSTRUCTIONS



# Important Safeguards

## For this appliance

- The jug warms up during operation. Do not touch the hot surfaces, always pick up the jug using the handle.
- The appliance shall not be placed in a cabinet when in use.
- Leave a space of 10 cm around the appliance.
- Make sure the lid is firmly closed.
- Do not open the lid during the use.
- Do not use the appliance in combination with parts or accessories from other manufacturers.
- The use of accessory attachments not recommended by the appliance manufacturer may result in fire, electric shock or injury to persons.
- Place the appliance on a flat, dry surface.
- Avoid wetting or spraying liquid on the appliance. In case of contact with liquid, immediately unplug the cord from the electrical outlet and dry thoroughly: Risk of electric shock!
- Do not use abrasive cleaners or sharp objects to clean the appliance.
- The use of an accessory not evaluated for use with this appliance may cause injuries.
- Do not install the appliance in environments with a temperature less than or equal to 0°C.
- Do not place the appliance on or in proximity of electric or gas cookers, or in a heated oven.
- Verify that there are no foreign objects inside the appliance.

- People who have pacemakers or other similar devices fitted must make sure that the operation of these devices is not affected by the induction field, the frequency range of which is between 20 and 50 kHz.

## Electrical Cord:

- a) A short power-supply cord is provided to reduce risks resulting from becoming entangled in or tripping over a longer cord.
- b) Longer detachable power-supply cords or extension cords are available and may be used if care is exercised in their use.
- c) If a long detachable power-supply cord or extension cord is used:
  1. The marked electrical rating of the detachable power-supply cord or extension cord should be at least as great as the electrical rating of the appliance;
  2. If the appliance is of the grounded type, the extension cord should be a grounding-type 3-wire cord; and
  3. The longer cord should be arranged so that it will not drape over the counter top or table top where it can be pulled on by children or tripped over.

## Connect the appliance

Make sure that the mains voltage corresponds with that indicated on the data plate on the bottom of the appliance.

Connect the appliance only to a power outlet installed perfectly with minimum capacity of 10A and with an efficient earth.

If the plug and power outlet are incompatible, have the power outlet replaced with a suitable type by qualified staff.

# SAVE THESE INSTRUCTIONS



# Important Instructions

## This user's manual

This user's manual is an integral part of the appliance and must be kept intact and available to the user throughout its life cycle.

## Use compliant with destination

This appliance is designed to heat and disc milk and to prepare hot chocolate; Do not use the product for purposes other than its intended use.

This appliance is intended for domestic use only.

## Manufacturer's liability

The manufacturer declines all liability for damage undergone by persons and objects due to:

- use of the appliance different from that envisioned;
- user manual has not been read;
- tampering of individual parts of the appliance;
- use of non-original spare parts;
- failure to comply with safety recommendations.

## Identification plate

The identification plate lists the technical data, serial number and brand name. The identification plate must never be removed.

## Disposal



### **Power voltage. Risk of electric shock.**

- Unplug the appliance.
- Unplug the cord from the wall outlet.

- **Old electrical equipment must not be disposed of with household waste!** In accordance with the law in force, electrical appliances at the end of their life should be taken to separate collection facilities for electrical and electronic waste. This is so that valuable materials from old appliances can be recycled and the environment can be protected. For more information, please contact your local authorities or recycling center employees.

Note that non-polluting and recyclable materials are used for packaging the appliance.

- Dispose of the packaging materials at appropriate differentiated waste collection centers.



### **Plastic packaging. Risk of suffocation.**

- Do not leave the packaging or any part of it unattended.
- Do not allow children to play with the plastic packaging bags.

# SAVE THESE INSTRUCTIONS



# Description / Assembly

## DESCRIPTION OF THE APPLIANCE (Fig. 1)

- 1 Motor base
- 2 Jug
- 3 Notched whisk (for frothing milk or chocolate)
- 3a Smooth whisk (for hot milk function)
- 4 Lid
- 5 Measuring cap
- 6 START/STOP button
- 7 Program selection knob
- 8 LEDs

## IDENTIFICATION PLATE

The identification plate states the technical data, serial number, and marking. The identification plate must never be removed.

## BEFORE FIRST USE (Fig.1)

- Carefully unpack the appliance and remove all packing materials and any labels and stickers.
- Clean the motor base (1) with a damp cloth. Wash all the components and dry thoroughly (see par. "Cleaning and Maintenance").



Before use, check that all the components are intact.

## ASSEMBLY OF COMPONENTS (Fig. 1)

- Place the jug (2) on the motor base (1).
- Place the whisk (3) inside the jug (2) by inserting it into the pin.
- Place the lid (4) on the jug (2) and press it downwards.

## DESCRIPTION OF CONTROLS (Fig. 1)

### Program selection knob (7)

The appliance is equipped with 6 preset programs and a manual function, which can be selected using the knob (7).

Knob icon	Program
	Hot chocolate
	Hot milk
	Hot milk with light froth
	Hot milk with thick froth
	Cold milk with light froth
	Cold milk with thick froth
<b>M</b>	Manual

## Liquid level indications

Symbol	Description
	Maximum milk filling level for heating function and chocolate preparation (including the amount of chocolate).
	Maximum milk filling level to be mounted.
	Minimum level.



## USE (Fig. 1)



### Recommendations for use

The result of the milk mount function can be influenced by the ingredients used.

Use whole milk for best results, removing it from the fridge immediately before pouring it into the jug (2).



After a first heating cycle, wait for the appliance to cool before starting a second one.



Do not use the appliance without liquids. Starting the appliance without liquids could damage the jug. Always fill up to the MIN level and not beyond the MAX level, both indicated inside the jug.



The appliance is in error status when the LED on the knob flashes and three acoustic signals are repeated twice.

The appliance displays an error status if the jug or whisk is not installed, the jug is removed during preparation or the cycle is started with an empty jug.

In the first two cases the cycle fails to start, while in the last two the cycle starts but stops after a few seconds.

- Insert the plug into the power outlet.
- The LED (8) flashes, after about 120 seconds of inactivity the appliance positions itself in stand-by and the LED turns off.

## Heat or froth the milk

- Remove the lid (4) and pour cold milk into the jug (2), referring to the level indications printed inside the jug itself.
- Refit the lid (4).
- Select the desired program by turning the knob (7) in correspondence with the red mark positioned on the knob ring.



The appliance passes from standby to the work phase.

- Press the START/STOP button (6) to start the cycle, the LED (8) lights up with a fixed light.
- An acoustic signal and the turning off of the LED (8) indicate the end of the cycle.
- It is possible to stop the cycle before the time set by pressing the START/STOP button (6).
- Remove the lid (4) holding it by the side flaps.
- Remove the jug (2) and pour the milk with the aid of a spoon.



It is best to add any sugar or sweetening syrups (e.g. honey, agave or maple juice, etc.) at the end of the cycle.

## Preparing hot chocolate

- Remove the lid (4) and pour the chocolate ingredients into the jug (2), referring to the level instructions printed inside the jug and the recommendations provided by the Smeg recipe.
- Select the relative program and proceed in the same way as for milk.



Powder ingredients can be added during the work phase by removing the measuring cap (5).

Add the ingredients gradually and in small amounts a few moments after the start of the cycle so that the milk



# Cleaning and maintenance

warms up. Adding the ingredients too quickly or in large amounts could cause the whisk to stop or detach from its housing.

## Manual function

- Remove the lid (4) and pour the milk into the jug (2), referring to the level indications printed inside the jug.
- Refit the lid (4).

You can select a hot cycle or a cold cycle.

### Hot Manual:

- Start the Manual Program (M), with heating function, by pressing the START/STOP button, the LED (8) lights up steadily; the speed of the whisk and the temperature increase proportionally to the duration of the cycle. The user can interrupt the cycle by pressing the START/STOP button whenever obtaining the desired result.

### Cold Manual:

- Keeping the START/STOP button pressed for about 3 seconds, the whisk starts to froth the milk without heating it and the LED (8) flashes for the entire duration of the cycle. The user can interrupt the cycle by pressing the START/STOP button whenever obtaining the desired result.



- In both cases, after a certain time, the manual function will automatically stop to preserve the safety and functionality of the product.
- An acoustic signal and the turning off of the LED (8) indicate the end of the cycle.
- Then proceed as described for milk.



You can remove the measuring cap (5) to add any powder ingredients (example: instant coffee, soluble cappuccino, soluble tea, etc.) during the work cycle.

## CLEANING AND MAINTENANCE (Fig. 1)



Before cleaning, ALWAYS disconnect the plug from the socket and allow the appliance to cool down. Never immerse the motor base (1) in water or other liquids.

The instruction manual contains appropriate instructions and provisions for cleaning, maintenance and operations recommended by the manufacturer to the customer. Any other intervention must be performed by an authorized service representative.

- Remove the whisk (3).
- Remove the jug (2) from the motor base.
- The whisk (3), the lid (4), the measuring cap (5) and the jug (2) can be washed in the dishwasher.
- The motor base (1) can be cleaned by first using a damp cloth and then a dry one. Do not use detergents or abrasive materials.



## **HOT CHOCOLATE**

Quantity for two cups

Ingredients

- |                               |        |
|-------------------------------|--------|
| - Whole milk                  | 250 ml |
| - Dark chocolate<br>in flakes | 90 gr  |

### **Instructions**

- Pour the milk into the jug.
- Add the chocolate flakes.
- Close the lid.
- Select the hot chocolate program ().
- Press the START/STOP button and wait for the program to finish.

## **CAPPUCCINO**

Quantity for two cups

Ingredients

- |                  |        |
|------------------|--------|
| - Whole milk     | 200 ml |
| - Coffee         | 80 ml  |
| or strong coffee | 40 ml  |

### **Instructions**

- Dispense coffee from a coffee machine and pour it into a cup.
- Pour the milk into the milk frother jug.
- Close the lid.
- Select the hot milk program with thick froth (.
- Press the START/STOP button and wait for the program to finish.
- Pour the milk froth onto the coffee.
- Add a teaspoon of sugar or sweetening syrup as desired.



## **EXPRESSO ICE COFFEE**

Quantity for two cups

Ingredients

- |              |        |
|--------------|--------|
| - Whole milk | 200 ml |
| - Coffee     | 80 ml  |
| - Ice cubes  | 4      |

### **Instructions**

- Put the ice cubes in 2 glasses.
- Dispense coffee from a coffee machine and pour it on ice in glasses.
- Add a teaspoon of sugar or sweetening syrup as desired.
- Pour the milk into the milk frother jug.
- Close the lid.
- Select the cold milk program with thick froth or light froth depending on result desired ( / .
- Press the START/STOP button and wait for the program to finish.
- Pour the milk froth into glasses with coffee and ice.

# What To Do If.....

## What To Do If.....

<b>Problem</b>	<b>Possible causes</b>	<b>Solution</b>
The appliance does not work.	Plug not connected.	Connect the plug.
The appliance stops during operation.	The jug is empty.	Fill the jug.
	The jug was removed during preparation.	Reposition the jug in the specific site.
	Ingredients too thick or too large like large chocolate chips.	Use finer ingredients.
The cycle does not start.	The jug has not been fitted.	Place the jug in the appropriate site.
	The whisk has not been fitted.	Check that the whisk has been installed and positioned properly.
The milk fails to froth.	Milk is not cold.	Use cold milk.
	The jug contains residual water or is dirty.	Make sure the jug is dry and clean.
	The whisk used is not correct.	Assemble the serrated whisk.
	Use of already frothed or heated milk.	Do not use milk that was frothed or heated.
	Use of low-fat milk.	Use the proper type of milk.
The ingredients do not dissolve.	The ingredients are too thick or too much.	Chop the ingredients before inserting them or check the preparation tips.



Contact local technical support if the problem is not solved or in case of other types of faults.



The manufacturer reserves the right to make any changes deemed useful for improvement of its products without prior notice. The illustrations and descriptions contained in this manual are therefore not binding and are merely indicative.

Le fabricant se réserve la faculté d'apporter, sans préavis, toutes les modifications qu'il jugera utiles pour l'amélioration de ses produits. Les illustrations et les descriptions figurant dans ce manuel ne sont pas contraignantes et n'ont qu'une valeur indicative.

El fabricante se reserva el derecho a aportar sin aviso previo todas las modificaciones que considere útiles para la mejora de sus propios productos. Las ilustraciones y las descripciones contenidas en este manual no comprometen, por tanto, al fabricante y tienen un valor meramente indicativo.