



RFD50XZA

CONTENTS

1	SAFETY FIRST	PAGE
1.1	Warning	1
1.2	Meanings of safety warning symbols	1
1.3	Electricity related warnings	2
1.4	Usage Appliance	2 to 3
1.5	Placement of items	3
1.6	Disposal	3

2	PROPER USE OF REFRIGERATOR	PAGE
2.1	Placement	4
2.2	Levelling Feet	5
2.3	Levelling Door	5
2.4	Changing the Light	6
2.5	Starting	6
2.6	Energy Saving	6

3	PROPER USE OF REFRIGERATOR	PAGE
3.1	Key Components	7 to 8
3.2	Display Functions	9 to 11

4	PROPER USE OF REFRIGERATOR	PAGE
4.1	Overall Cleaning	12
4.2	Cleaning of the door tray	13
4.3	Defrosting	13
4.4	Out of Operation	13
4.5	Moving	13

5	PROPER USE OF REFRIGERATOR	PAGE
5.1	Trouble Shooting	14 to 15

6	CONTACT INFORMATION	
6.1	Contact Us	

1. SAFETY FIRST

1.1 Warning and Safety Information

Please read the operating and installation instructions carefully! They contain important information on how to install, use and maintain the appliance. The manufacturer is not liable if you fail to comply with the instructions and warnings.

This appliance is intended to be used in household and similar applications such as staff kitchen areas in shops, offices and other working environments; farm houses and by clients in hotels, motels and other residential type environments; bed and breakfast type environments; non- retail or commercial catering applications.

The appliance must be unplugged if not in use and before carrying out user maintenance on the appliance or the installation of an accessory.

Do not use electrical appliances inside the food storage compartments of the appliance.

Refrigerant and cyclopentane foaming material used for the appliance are flammable. Therefore, when the appliance is scrapped, it shall be kept away from any fire source and be recovered by a special recovering company with corresponding qualification other than be disposed by combustion, so as to prevent damage to the environment or any other harm.

If damage has occurred and refrigerant escapes, keep naked flames and/or ignition sources away from the appliance, thoroughly ventilate the room for several minutes, switch off the appliance and pull out the mains plug and contact the customer service department.

To avoid contamination of food, please respect the following instructions:

Opening the door for long periods can cause a significant increase of the temperature in the compartments of the appliance.

Clean surfaces regularly and accessible drainage systems.

Store raw meat and fish in suitable containers in the refrigerator, so that it is not in contact or may drip onto other food.

If the refrigerating appliance is left empty for long periods, switch off, defrost, clean, dry, and leave the door open to prevent mold developing within the appliance.

1.2 Meaning of safety warning symbols



This is a prohibition symbol.

Any in compliance with instructions marked with this symbol may result in damage to the product or endanger the personal safety of the user.



This is a warning symbol.

It is required to operate in strict observance of instructions marked with this symbol; or otherwise damage to the product or personal injury may be caused.



This is a cautioning symbol.

Instructions marked with this symbol require special caution. Insufficient caution may result in slight or moderate injury, or damage to the product.

This manual contains lots of important safety information which shall be observed by the users.

1.3 Electricity related warnings

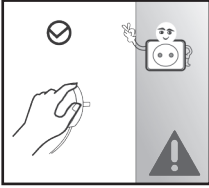

- Do not pull the power cord when pulling the power plug of the refrigerator. Please firmly grasp the plug and pull out from the socket directly.
- To ensure safe use, do not damage the power cord and do not use appliance if the power cord is damaged or worn.
- If supply cord is damaged, it must be replaced by the manufacturer, its service agent or similarly qualified persons in order to avoid a hazard.
- Do not locate multiple portable socket-outlets or portable power supplies at the rear of the appliance.
- Do not use extension cords or ungrounded adapters.

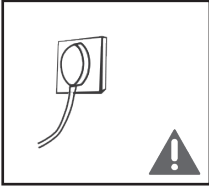

- Please use a dedicated power socket. The power socket shall not be shared with other electrical appliances. The power plug should be firmly contacted with the socket or else fires might be caused.
- Please ensure that the grounding electrode of the power socket is equipped with a reliable grounding line.

1.4 Using Appliance

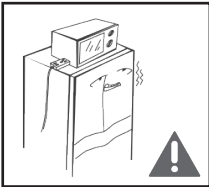

- Do not use electrical appliances on the top of the appliance.

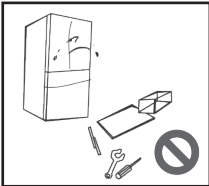

- Do not disassemble or reconstruct the refrigerator, nor damage the refrigerant circuit; maintenance of the appliance must be conducted by a specialist.
- Damaged power cord must be replaced by the manufacturer, its maintenance department or related professionals in order to avoid danger.
- Do not damage the refrigerant circuit.

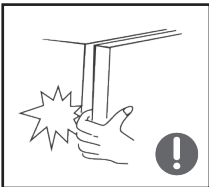

- The gaps between refrigerator doors and between doors and refrigerator body are small, be noted not to put your hand in these areas to prevent from squeezing the finger. Please be gentle when closing the refrigerator door to avoid falling articles.
- Do not pick foods or containers with wet hands in the freezing chamber when the refrigerator is running, especially metal containers in order to avoid frostbite.



- Do not allow any child to get into or climb the refrigerator; otherwise suffocation or a falling injury of the child may be caused.
- Children under the age of 8 years should have adult supervision

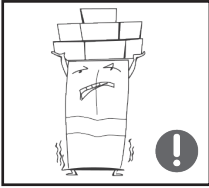

- Do not place heavy objects on the top of the refrigerator considering that objects may fall when closing or opening the door, and accidental injuries might be caused.
- Please pull out the plug during the cleaning process and wait five minutes before re-activating the power supply to prevent damages to the compressor due to successive starts.

1.5 Placement of items

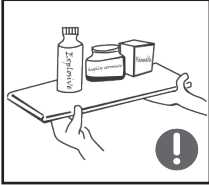

- Do not put flammable, explosive, volatile and highly corrosive items in the refrigerator to prevent damages to the product or fire accidents.
- Do not place flammable items near the refrigerator to avoid fires

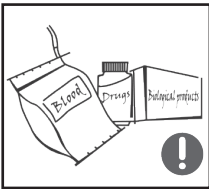

- The refrigerator is intended for household use, such as storage of foods and shall not be used for other purposes, such as storage of blood, drugs, or biological products, etc.

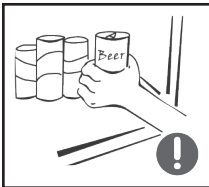

- Do not store beer, beverage or other fluid contained in bottles or enclosed container in the freezing chamber of the refrigerator; or otherwise the bottles or enclosed containers may crack due to freezing and cause damages.

1.6 Disposal

Refrigerant and cyclopentane foaming material used for the refrigerator are flammable. Therefore, when the refrigerator is scrapped, it shall be kept away from any fire source and be recovered by a special recovering company with corresponding qualification other than be disposed by combustion, so as to prevent damage to the environment or any other harm.

When the refrigerator is scrapped, disassemble the doors, and remove gasket of door and shelves; put the doors and shelves in a proper place, so as to prevent trapping of any child.



Correct Disposal of this product:

This marking indicates that this product should not be disposed with other household wastes throughout South Africa. To prevent possible harm to the environment or human health from uncontrolled waste disposal, recycle it responsibly to promote the sustainable reuse of material resources.

2. PROPER USE OF REFRIGERATORS

2.1 Placement

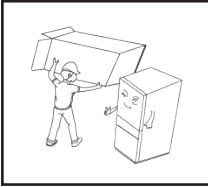

- Before use, remove all packing materials, including bottom cushions, foam pads and tapes inside of the refrigerator; tear off the protective film on the doors and the refrigerator body.

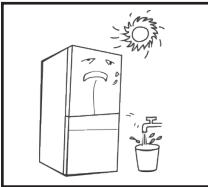

- Keep away from heat and avoid direct sunlight. Do not place the freezer in moist or watery places to prevent rust or reduction of insulating effect.

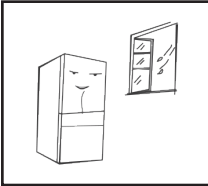

- The refrigerator is placed in a well-ventilated indoor place; the ground shall be flat, and sturdy (rotate left or right to adjust the wheel for levelling if unstable).

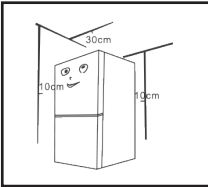

- The top space of the refrigerator shall be greater than 30cm, and the refrigerator should be placed against a wall with a free distance more than 10cm to facilitate the heat dissipation.

Precautions before installation:

Before installation or adjusting of accessories, it shall be ensured that the refrigerator is disconnected from power. Precautions shall be taken to prevent fall of the handle from causing any personal injury.

When positioning the appliance, ensure the supply cord is not trapped or damaged.

2.2 Levelling feet

Graphic diagram of the levelling feet

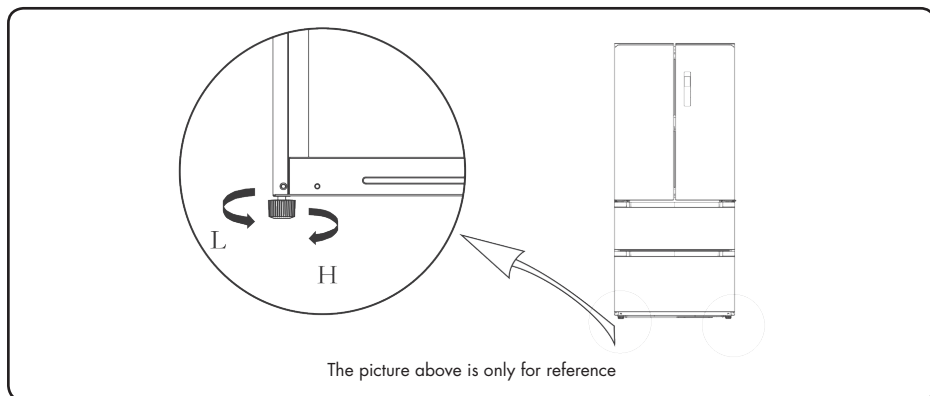

Adjusting procedures:

1. Turn the feet clockwise to raise the refrigerator;
2. Turn the feet counterclockwise to lower the refrigerator;
3. Adjust the right and left feet based on the procedures above to a horizontal level.

2.3 Levelling door

Graphic diagram of leveling the door

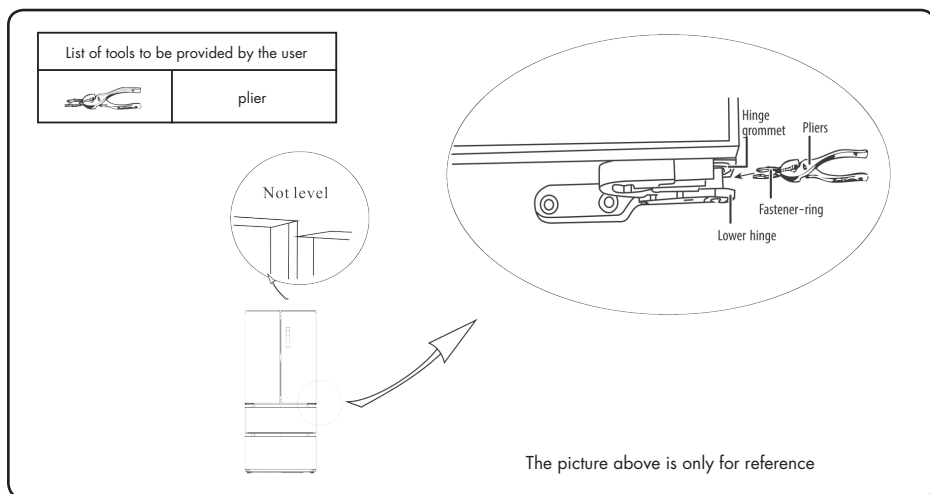

Adjusting procedures:

1. Raise the lower door up to the level of the higher door.
2. Insert the supplied fastener-ring by using plier in the gap between the hinge-grommet and the lower hinge.
3. The number of fasten-rings you will need to insert depends on the gap.

2.4 Changing the Light

Any replacement or maintenance of the LED lamps is intended to be made by the manufacturer, its service agent or similar qualified person.

2.5 Starting to use

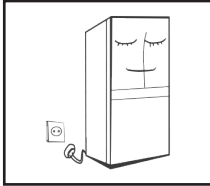

- Before initial start, keep the refrigerator still for two hours before connecting it to power supply.
- Before putting any fresh or frozen foods, the refrigerator shall have run for 2-3 hours, or for above 4 hours in summer when the ambient temperature is high.

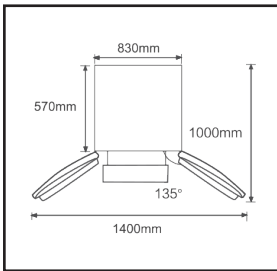

- Ensure enough space for convenient opening of the doors and drawers.

2.6 Energy saving tips

- The appliance should be placed in the coolest area of the room, away from heat producing appliances or heating ducts, and out of the direct sunlight.
- Let hot foods cool to room temperature before placing in the appliance.
- Overloading the appliance forces the compressor to run longer. Foods that freeze too slowly may lose quality or spoil.
- Be sure to wrap foods properly, and wipe containers dry before placing them in the appliance. This cuts down on frost build-up inside the appliance.
- Appliance storage bin should not be lined with aluminum foil, wax paper, or paper toweling. Liners interfere with cold air circulation, making the appliance less efficient.
- Organize and label food to reduce door openings and extended searches. Remove as many items as needed at one time, and close the door as soon as possible.

3. STRUCTURE AND FUNCTIONS

3.1 Key components

(Refrigerating chamber)

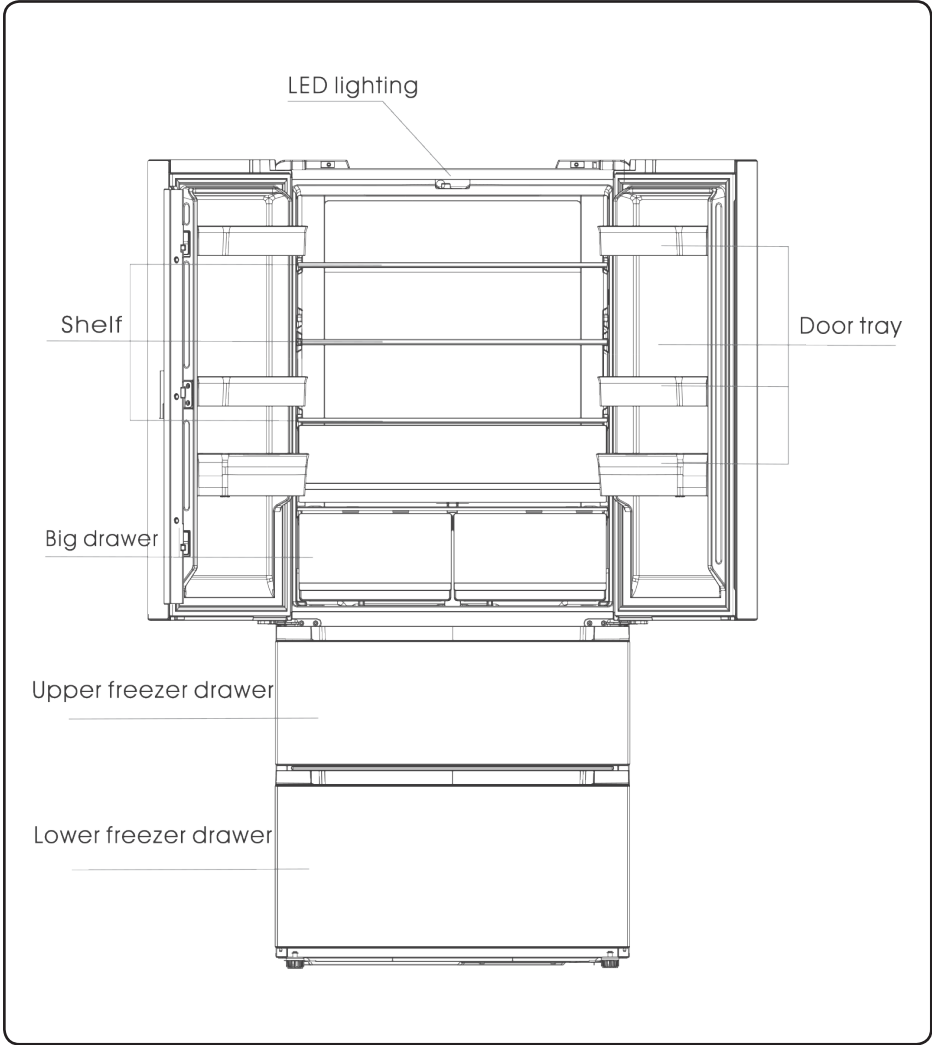

(The picture above is only for reference. The actual configuration will depend on the physical product or statement by the distributor)

3.1.1 Refrigerating chamber

- The Refrigerating Chamber is suitable for storage of a variety of fruits, vegetables, beverages and other food consumed in the short term. **Suggested storage time 3 days to 5 days.**
- Cooked or hot food shall not be put in the refrigerating chamber until cooled to room temperature.
- Foods are recommended to be sealed up before putting into the refrigerator.
- The glass shelves can be adjusted up or down for a reasonable amount of storage space and easy use.
- Radar Sensor - Smart Sensor detects temperature and adjust fridge for faster and more accurate cooling, thus keeping freshness and nutrition of food.
- Special **Pt Fresh** technology delivers a healthier and fresher air inside the refrigerator.

Fresh Zone Drawer – This drawer is cooler than the rest of the refrigerator ideal for storage of Different cuts of meat and Fish.

Moisture Drawer – Selecting between the low or high, this helps fruits and vegetables stored inside to remain crisp, moist and fresh for a longer time. The general guideline is Low Humidity – Primarily Fruit and High Humidity – Primarily Vegetables

Flex-Zone Drawer – you are able to adjust the humidity according to what you are placing inside the drawer from Cold Drinks/ Dry Goods or Fruit and Vegetables.

3.1.2 Freezing chamber

- The low temperature freezing chamber may keep food fresh for a long time and it is mainly used to store frozen foods and making ice.
- The freezing chamber is suitable for storage of meat, fish, rice balls and other foods not to be consumed in short term.
- Chunks of meat are preferably to be divided into small pieces for quick freezing and easy access.
- Please note that food should be consumed within the shelf time.

Freeze-Zone Drawer – this is the quick freezer chamber and items would freeze quicker in this compartment

Drawers, food boxes, shelves, etc. placed according to the position in the picture above are the most energy efficient.

Note: Storage of too much food during operation after the initial connection to power may adversely affect the freezing effect of the refrigerator. Foods stored shall not block the air outlet; or otherwise the freezing effect will also be adversely affected.

3.2 Display Functions

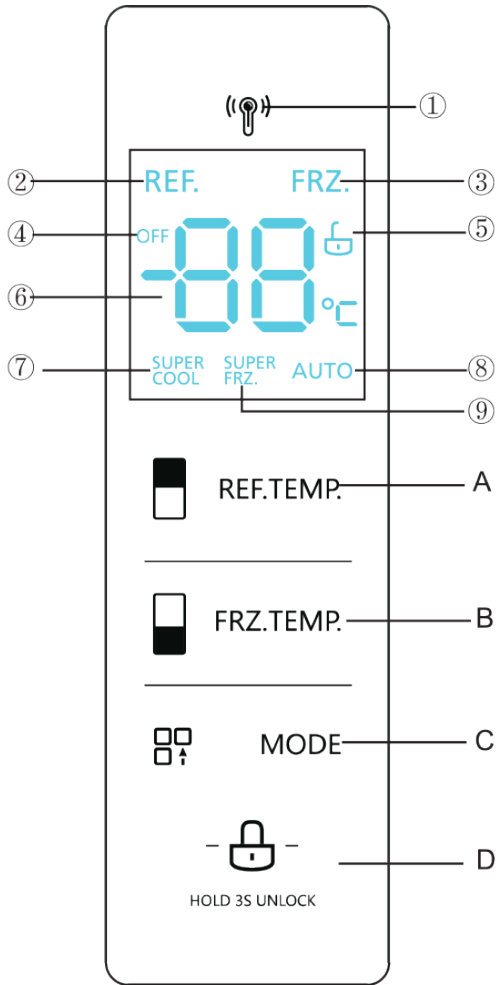

The picture above is only for reference.

- | | | |
|-------------------|----------------------|----------------------------|
| ① Radar icon | ② Refrigerating icon | ③ Freezing icon |
| ④ OFF icon | ⑤ Lock/Unlock icon | ⑥ Temperature display area |
| ⑦ Super cool icon | ⑧ AUTO icon | ⑨ Super freezing icon |

Control buttons

A	REFRIGERATOR TEMPERATURE	B	FREEZER TEMPERATURE
C	MODE SELECTION	D	LOCK / UNLOCK BUTTON

Operation instructions

1) Display

- When you turn on the power to the refrigerator, the display screen will total display for 3 seconds. Meanwhile the starting up bell rings and then the screen enters the normal display of the operation.
- The first time for using the refrigerator, the default set temperature of refrigerating chamber and freezing chamber is 5° C / -18 ° C respectively.
- When an error occurs, the display shows the error code (see next page); during normal running, the display shows the set temperature of the refrigerating chamber or freezing chamber.
- Under normal circumstances, if there is no operation on display panel or door opening action within 30s, then the display is locked, and the state 6 goes out.

2) Lock /unlock

- In the unlocked state, long press the lock button **D** for 3 seconds, enter the lock state, The logo **6** goes out and buzzer sounds, it means the display panel is locked, at this time, button operation cannot be implemented; In the locked state, long press the lock button **D** for 3 seconds, enter the unlocked state, The logo **6** lights up and buzzer sounds, it means the display panel is unlocked, at this time, button operation can be implemented.

3) Temperature setting of refrigerating compartments.

- Press temperature adjusting button of the refrigerating compartment A to change the setting temperature of refrigerating chamber, and then each time a press of temperature adjusting button of the refrigerating compartment, the temperature will be reduced 1° C.
- The temperature setting range for refrigerating chamber is 2-8° C.
- When the temperature is 2° C, press the button again, and the temperature of refrigerating chamber will be set at 80° C, and it circulates accordingly.

4) Temperature setting of freezing compartments

- Press temperature adjusting button of the freezing compartments B to change the setting temperature of freezing compartment and then each time a press of temperature adjusting button of the freezing compartment the temperature will be reduced 1° C;
- The temperature setting range for freezing compartment is -24°C~-16°C). When the temperature is -24°C, press the button again, and the temperature of freezing chamber will be set at -16°C, and it circulates accordingly.

5) Mode setting

- When super cool mode 7 is set, temperature of refrigerating chamber will automatically set at 2°C, Super cool exits for 6 hours.
- Exit super cool mode 7, temperature of refrigerating chamber will automatically return back to temperature set before super cool mode.
- When super freezing mode 9, is set, temperature of freezing chamber will automatically set at -24°C, Super freezing exits for 24h.
- Exit super freezing mode 9, temperature of freezing chamber will automatically return back to temperature set before super freezing mode.
- Vacation mode 8, is set, temperature of freezing chamber will be automatically set at -18°C; the temperature of refrigerating chamber will be automatically set at 5°C

Recommended setting: refrigerating chamber 4°C, freezing chamber - 18°C.

6) Storage upon power failure

In case of power failure, the instant working state will be locked and maintained till re-electrification.

7) Fault indication

The following warnings appearing on the display indicate corresponding faults of the refrigerator. Though the refrigerator may still have cold storage function with the following faults, the user shall contact Smeg to book a service call for maintenance, so as to ensure optimized operation of the appliance.

E1	Temperature sensor failure of refrigerating compartment
E2	Temperature sensor failure of freezing compartment
E4	Failure of defrosting sensor in refrigerating compartment
E5	Freezing defrost sensor detection circuit error
E6	Communication error
E7	Circulation of temperature detection circuit error
EH	Moisture sensor indicator

4. MAINTENANCE AND CARE OF THE REFRIGERATORS

4.1 Overall cleaning

- Please turn off the power before cleaning interior, remove all foods, drinks, shelves, drawers, etc.
- Do not use soap, detergent, scrubbing powder, spray cleaner, abrasive or acidic agents etc. as these may cause odors in the interior of the refrigerator or contaminated food.
- Wipe the outer surface of the refrigerator with a soft cloth dampened with soapy water, detergent, etc., and then wipe dry.
- The interior of the refrigerator should be cleaned regularly to avoid odor.
- Use a soft cloth or sponge to clean the inside of the refrigerator with two tablespoons of baking soda and a quart of warm water. Then rinse with water and wipe clean. After cleaning, open the door and let it dry naturally before turning on the power.
- Check the door gasket regularly to make sure there is no debris. Clean the door gasket with a soft cloth dampened with soapy water or diluted detergent.
- For areas that are difficult to clean in the refrigerator (such as narrow spaces, gaps or corners), it is recommended to wipe them regularly with a soft rag, soft brush, etc. and when necessary, combined with some auxiliary tools (such as thin dial sticks) to ensure no contaminants or bacterial accumulation in these areas.
- Clean the bottle frame, shelves and drawers with a soft cloth dampened with soapy water or diluted detergent. Dry with a soft cloth or dry naturally.
- Do not use hard brushes, wire brushes, abrasives (such as toothpaste), organic solvents (such as alcohol, acetone, banana oil etc), boiling water, acid or alkaline items, which may damage the fridge surface and interior certain products could also deform and damage plastic parts.
- Do not rinse directly with water or other liquids during cleaning to avoid short circuits or affect electrical insulation after immersion.



Please unplug the refrigerator for defrost and cleaning.

4.2 Cleaning of door tray

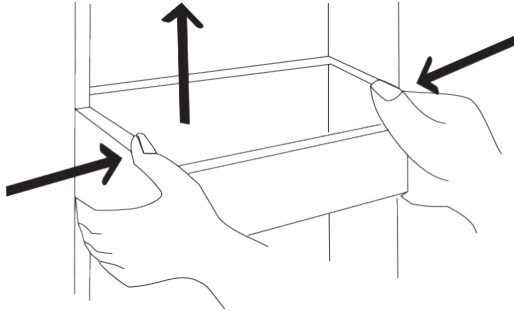

The picture above is only for reference.

- According to the direction arrow in the figure above, use both hands to squeeze the tray, and push it upward, then you can take it out.
- After washing the tray having been taken out, you can adjust its installing height in accordance with your requirement.

4.3 Defrosting

The refrigerator is made based on the air-cooling principle and thus has automatic defrosting function. Frost formed due to change of season or temperature may also be manually removed by disconnection of the appliance from power supply or by wiping with a dry towel.

4.4 Out of operation

- Power failure: In case of power failure, even if it is in summer foods inside the appliance can be kept for several hours; during the power failure, the times of door opening shall be reduced, and no more fresh food shall be put into the appliance.
- Not in use: The appliance shall be unplugged and then cleaned; then the doors are left open to prevent odor.

4.5 Moving

- Before the refrigerator is moved, take all objects inside out, fix the glass partitions, vegetable holder, freezing chamber drawers and etc. with tape, and tighten the levelling feet; close the doors and fix them with tape.
- During moving, the appliance shall not be laid upside down or horizontally, or be vibrated; the inclination during movement shall be no more than 45°
- At new destination, the refrigerator needs to stand in new location for 4 hours before turning on the powers supply.

TROUBLE SHOOTING

You may try to solve the following simple problems by yourself.

Failed operation	Check whether the appliance is connected to power or whether the plug is in well contact
	Check whether the voltage is too low
	Check whether there is a power failure or partial circuits have tripped
Odor	Odorous foods shall be tightly wrapped Check whether there is any rotten food. Clean the inside of the refrigerator
Long-time operation of the compressor	Long operation of the refrigerator is normal in summer when the ambient temperature is high
	It is not suggestible having too much food in the appliance at the same time. Food shall get cool before being put into the appliance
	The doors are opened too frequently
Light fails to get lit	Check whether the refrigerator is connected to power supply and whether the illuminating light is damaged
	Have the light replaced by a specialist
Doors cannot be properly closed	The door is stuck by food packages Too much food is placed
	The refrigerator is tilted
Loud noise	Check whether the floor is level and whether the refrigerator is placed stably. Check whether accessories are placed at proper locations
Door seal fails to be tight	Remove foreign matters on the door seal
Water pan overflows	There is too much food in the chamber or food stored contains too much water. Resulting in heavy defrosting
	The doors are not closed properly, resulting in frosting due to entry of air and increased water due to defrosting
Hot housing	Heat dissipation of the built-in condenser via the housing, which is normal When housing becomes hot due to high ambient temperature, storage of too much food or shutdown of the compressor is shut down, provide sound ventilation to facilitate heat dissipation
Surface condensation	Condensation on the exterior surface and door seals of the refrigerator is normal when the ambient humidity is too high. Just wipe the condensate with a clean towel.
Abnormal noise	Buzz: The compressor may produce buzzes during operation, and the buzzes are loud particularly upon start or stop. This is normal.
	Creak: Refrigerant flowing inside of the appliance may produce creak, which is normal.

Climate classes

This refrigerating appliance is intended to be used in the ambient temperatures shown below

Class	Symbol	Ambient temperature range
Extended temperate	SN	+10° to +32°
Temperate	N	+16° to +32°
Subtropical	ST	+16° to +38°
Tropical	T	+16° to +43°

SERVICE CENTRE CONTACT INFORMATION

Website

www.smeg.co.za

Email address

service@smegsa.co.za

Contact number

011-656-0025



