

## IMPORTANT SAFETY INSTRUCTIONS



**READ AND SAVE THESE INSTRUCTIONS** – Your Safety And the Safety of Others Are Very Important. We have provided many important safety messages throughout this manual and on your appliance. Read all instructions before using your appliance and always obey all safety messages.



### RECOGNIZE SAFETY INFORMATION

This is a safety alert symbol. This symbol alerts you to potential hazards that can kill or hurt you and others.

### UNDERSTAND SIGNAL WORDS

A signal word – DANGER, WARNING, or CAUTION – is used with the safety-alert symbol. DANGER identifies the most serious hazards. It means you can be killed or seriously injured if you do not immediately follow instructions. WARNING means you can be killed or seriously injured if you do not follow instructions. CAUTION indicates a potentially hazardous situation which, if not avoided, may result in minor or moderate injury.

All safety messages will inform you as to potential hazards, inform you on how to reduce the risk of injury and as to what can occur if the instructions are not followed.

**IMPORTANT: Observe all government codes and ordinances.**

**WARNING: For your safety, the information in this manual must be followed to minimize the risk of fire or explosion, or to prevent property damage, personal injury or death.**

- This conversion kit must be installed by a qualified service agency in accordance with the manufacturer's instructions and all applicable codes and requirements of the authority having jurisdiction.
- The qualified service agency is responsible for the proper installation of this kit.
- The installation shall not be considered to be correct and completed until the operation of the converted appliance is checked as specified in the manufacturer's instructions supplied with this kit.



### WARNING



### FIRE HAZARD

Securely tighten all gas connections. If connected to LP, have a qualified person ensure that the gas pressure does not exceed 14" water column. Examples of a qualified person include licensed heating personnel, authorized gas company personnel, and authorized service personnel.

**FAILURE TO DO SO CAN RESULT IN DEATH, EXPLOSION, OR FIRE.**



1)

Check that the main gas supply line to the range is shut off and that the power supply cord is disconnected.

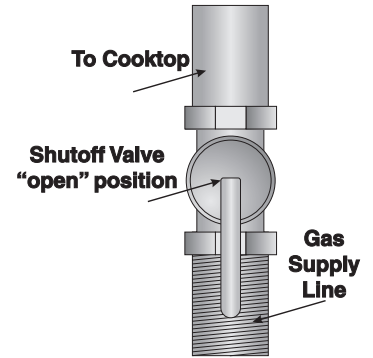

2)

Remove access cap "A" by using a screwdriver or a quarter, turning the access cap anti-clockwise. The gas pressure regulator has two settings which are indicated on two sides of the cap. Turn the cap and reinstall it in the regulator with "LP" visible from the outside of the regulator.

The regulator must be checked at a minimum water column of 1 inch (2.5 cm) above the set pressure. The inlet pressure to the regulator should be as follows for operation and checking the regulator setting: - NATURAL GAS: Set pressure at 4" w.c. Supply pressure of 3 1/2" - 10 1/2" w.c. maximum; - LP GAS: Set pressure at 11" w.c. . Supply pressure of 8" - 13" w.c. maximum.



The cooktop must be isolated from the gas supply piping system by closing the respective manual shut-off valve during any pressure testing of the gas supply piping system at test pressures equal to or greater than 1/2 psig (3.5 kPa).



## Conversion Kit

EN

**3)**

- 1 Remove the grids and all the caps and flame-spreader crowns;
- 2 Unscrew the burner nozzles with a 7 mm socket wrench;
- 3 Replace the nozzles according to the type of gas to be used (see point "4").
- 4 Replace the burners in the correct position.

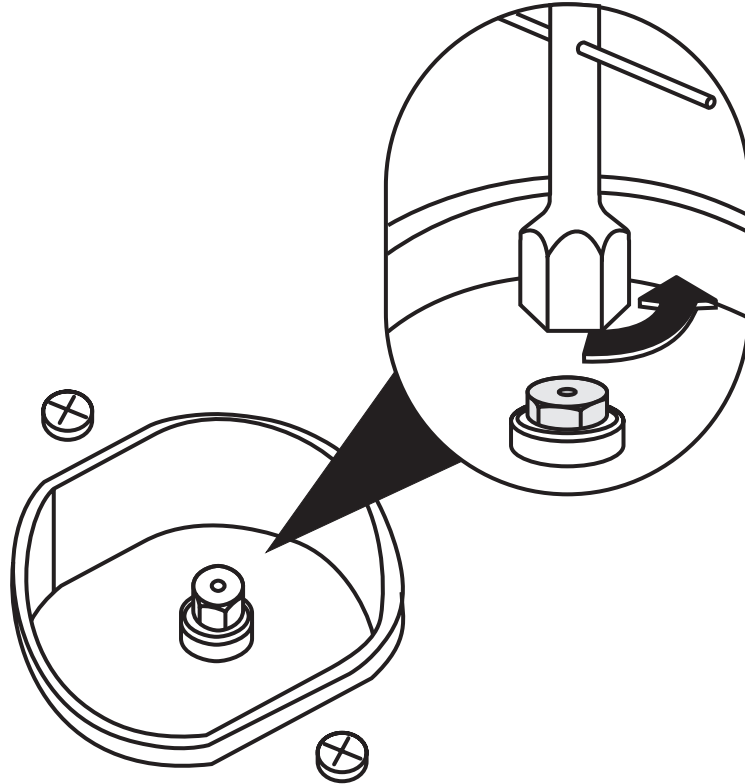



**4)** To adjust the cooktop for LP gas or to return to Natural Gas use, refer to the tables here below.

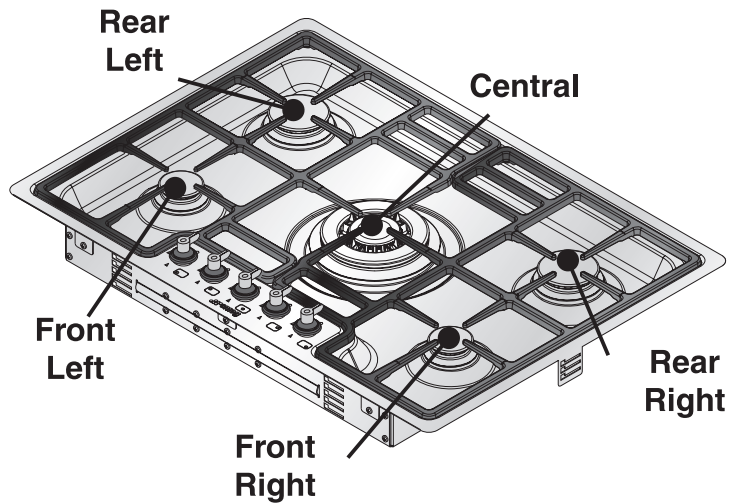

Natural gas			
	Qt	Injector	Qr
	BTU	Ø mm	BTU
Front Right	3400	0.90	1200
Front Left	3400	0.90	1200
Central	13000	1.75	4000
Rear Right	6200	1.20	1500
Rear Left	6200	1.20	1500

LP				
	Qt	Injector	Qr	by-pass
	BTU	Ø mm	BTU	mm
Front Right	3400	0.54	1200	0.32
Front Left	3400	0.54	1200	0.32
Central	13000	1.02	4000	0.63
Rear Right	6200	0.72	1500	0.38
Front Left	6200	0.72	1500	0.38



**NOTE:** Save the orifices removed from the appliance for future use.

**5)** After carrying out the above adjustments, remount in reverse order to the instructions given in point “3”.  
**Caution:** refit all flame caps in the same points from which they were removed. In fact, it is not possible to change the flame cap positions. After refitting them, ensure that they are perfectly in place and that there is no clearance between the cooktop and the flame caps.

**FIRE HAZARD**



**WARNING**



- Use a soapy solution to check for proper tightness.
- Never test for gas leaks with a match or other flames.
- Failure to follow this instruction can result in death or fire





## Conversion Kit



Leak testing of the appliance must be conducted according to the following instructions:  
Use a brush and liquid detergent to test all gas connections for leaks. Bubbles around connections indicate a leak. If a leak appears, shut off gas valve controls and adjust connections.  
Then check the connections again.

6)

### **NEVER TEST FOR GAS LEAKS WITH A MATCH OR OTHER FLAMES.**

Remove all of the detergent solution from the cooktop.

#### **Electronic Ignition System - initial lighting**

Cooktop burners use electronic igniters rather than standing pilots. When the cooktop control knob is pushed in and turned to the "△" position, the system lights a spark to ignite the burner. This sparking continues until the control knob is turned to the desired setting.



7)

Check the operation of the cooktop burners. Push in and turn each control knob to the maximum flame position (△). The flame should light within 4 seconds.

If the burners do not light properly, turn the control knob to the O position. Ensure that the burner cap is in the proper position. Ensure that the power supply cord is plugged in and that the circuit breaker or house fuse has not blown. Ensure that the shut-off valve is on the "ON" position. Check operation again. If a burner does not light at this point, contact your SMEG dealer for assistance.

8)

Replace the components on the burner and turn the knobs on the gas tap pins.

Light the burner and set it at minimum △.

Remove the knob and turn the regulation screw next to the gas tap pin until you obtain a suitable minimum flame.

Replace the knob and check flame stability by rapidly turning the knob from maximum to minimum. The flame should not go out.

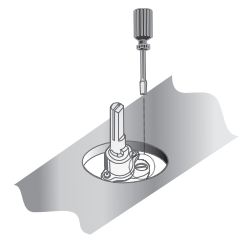

9

Check flame at the maximum flame position (△) for a blue color. It should be clean and soft in character. No blowing or lifting of flame should occur. Occasional orange flashes are normal and reflect different elements in the air or gas.

10)

Completely fill out conversion label (part no. XXXXXXXX) and attach the label to the bottom of the cooktop beside the rating tag. Do not cover the rating tag with the conversion label.

11)

At higher altitudes, no further adjustments are necessary. Derating the burners is also unnecessary.

12)

Save the orifices removed from the unit along with these instructions for possible future use.

#### **NATURAL GAS:**

To convert back to Natural Gas: Follow steps 3 through 11 and replace orifices in the order in which they were removed.